

## BOGOTA INTERNATIONAL ART FAIR - ArtBo 2010

### GENERAL INFORMATION

#### 1.- REGISTRATION

Adjunto a la Solicitud de Admisión, usted deberá anexar la siguiente documentación junto con el recibo de pago de los derechos de inscripción:

Along with the Admission Request, you must attach the following documents as well as the payment receipt of the registration rights.

Documents for National Galleries	Documents for International Galleries
<ul style="list-style-type: none"> <li>➤ Existence Certificate and Legal Representation issued by the Bogotá Chamber of Commerce (Original, not older than 90 days since the date of issue)</li> <li>➤ Copy of the RUT</li> <li>➤ Copy of the Legal Representative´s Identity Card.</li> </ul>	<ul style="list-style-type: none"> <li>➤ Copy of the Legal Representative´s identification document.</li> <li>➤ Resolución that approves the operation of the company in its country.</li> </ul>

#### 2.- PRICES AND PAYMENT DATES

REGISTRATION RIGHTS	PRICES	PAYMENT DATE
REGISTRATION RIGHTS	USD \$ 130.00	Until: June 30 / 2010
Gallery Stands	PRICES	PAYMENT DATE
More than 63 m <sup>2</sup> (m <sup>2</sup> USD 215)	USD \$ 13.545.00	First payment: July 30 <sup>th</sup> / 2010 Second payment: September 10 <sup>th</sup> / 2010.
63 m <sup>2</sup> (m <sup>2</sup> USD 198)	USD \$ 12.474.00	
33.75 m <sup>2</sup> (m <sup>2</sup> USD 198)	USD \$ 6.683.00	
22 m <sup>2</sup> (m <sup>2</sup> USD 215)	USD \$ 4.730.00	
CATÁLOG	PRICES	PAYMENT DATE
2 pages	USD \$ 440.00	Total payment: 30 de Julio de 2010.
1 page * *(only for individual projects)	USD \$ 220.00	
INDIVIDUAL PROJECTS	PRICES	PAYMENT DATE
10 m <sup>2</sup> (m <sup>2</sup> USD 198)	USD \$ 1.910.00	First payment: July 30 <sup>th</sup> / 2010 Segundo pago: September 10 <sup>th</sup> / 2010.

Note: A copy of the deposit must be attached with the Admission Request. Otherwise, the application will not be taken into account and will not be valid. These payments are not refundable.

Corferias will only receive cash payments in Colombian pesos, considering the representative market exchange rate.

### 3.- PAYMENT OPTIONS

All payments can be made by a deposit or by a bank transfer to CORPORACIÓN DE FERIAS Y EXPOSICIONES S.A. on the following accounts:

ACCOUNT IN PESOS	ACCOUNT IN DÓLLARS
<p>BANK: POPULAR Branch: Feria Exposición Savings Account #: 025 720160 Bogotá - Colombia</p> <p>Code: 23 Invoice: 232010</p>	<p>BANK: BANCOLOMBIA AGENCY: Miami Address: 1111 Brickell Avenue Suite 1550 Miami, FI 33131 TELÉPHONE: (305) 373 39 69 Account #: 11200253 ABBA: 066015518 SWIFT COLOUS33 City: Miami</p>

NO checks will be received. Credit Card payments must be made personally .

### 4.- STANDS TECHNICAL SPECIFICATIONS

63 m²: 20 linear meters of internal perimeter for Works, by 3.66m of height. Storage room of 6 x 1.5 m. 13 light spots. Includes 1 table and 2 chairs. Exterior stand signaling included.

Includes:

- 40 invitations to ArtBo´s opening
- 3 permanent rosettes by exposor
- 3 permanent service rosettes
- 5 rosettes for mounting and unmounting (only valid during the stablished dates)
- 10 courtesy passes
- 5 Artbo catalogs



STAND MODELO DE 63.00 M2 IZQUIERDO. (PUEDE SER DERECHO SEGUN LOCALIZACION)

13 SPOTS PARA STAND MEDIANERO Y 16 PARA STAND ESQUINERO  
20 ML DE PERIMETRO INTERNO POR 3.66 MTS DE ALTURA (NO INCLUYE 1 ML DE PUERTA)  
1.50 ML DE PERIMETRO EXTERNO ADICIONAL POR 3.66 MTS DE ALTURA PARA STAND MEDIANERO  
7.50 ML DE PERIMETRO EXTERNO ADICIONAL POR 3.66 MTS DE ALTURA PARA STAND ESQUINERO  
—○ SPOT BRAZO SENCILLO EXTENDIBLE, BOMBILLA HALOGENA DE 150 WATTS / 110V  
⊙ TOMACORRIENTE DOBLE 1500 WATTS / 110V

33 m<sup>2</sup>: 13,5 linear meters of internal perimeter for Works, by 3.66m of height. Storage room of 6 x 1.5 m. 11 light spots. Includes 1 table and 2 chairs. Exterior stand signaling included.

Incluye:

- 30 invitations to ArtBo´s opening
- 3 permanent rosettes by exposer
- 2 permanent service rosettes
- 5 rosettes for mounting and unmounting (only valid during the stablished dates)
- 7 courtesy passes
- 3 Artbo catalogs

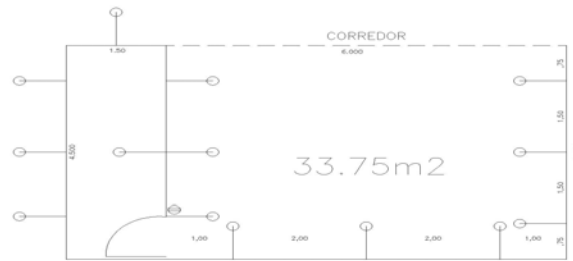

STAND MODELO DE 33.75 M2 DERECHO. (PUEDE SER IZQUIERDO SEGUN LOCALIZACION)

11 SPOTS PARA STAND MEDIANERO Y 14 PARA STAND ESQUINERO  
13.50 ML DE PERIMETRO INTERNO POR 3.66 MTS DE ALTURA. ( NO INCLUYE 1 ML DE PUERTA)  
1.50 ML DE PERIMETRO EXTERNO ADICIONAL POR 3.66 MTS DE ALTURA PARA STAND MEDIANERO  
6.00 ML DE PERIMETRO EXTERNO ADICIONAL POR 3.66 MTS DE ALTURA PARA STAND ESQUINERO  
—○ SPOT BRAZO SENCILLO EXTENDIBLE, BOMBILLA HALOGENA DE 150 WATTS / 110V  
⊙ TOMACORRIENTE DOBLE 1500 WATTS / 110V

22 mts<sup>2</sup>: 11 linear meters of internal perimeter, by 3.66 of height. Storage room of 6 x 1.5 m. 9 light spots. Includes 1 table and 2 chairs. Exterior stand signaling included.

Incluye:

- 20 invitations to ArtBo´s opening
- 2 permanent rosettes by exposer
- 2 permanent service rosettes
- 5 rosettes for mounting and unmounting (only valid during the stablished dates)
- 5 courtesy passes
- 2 Artbo catalogs

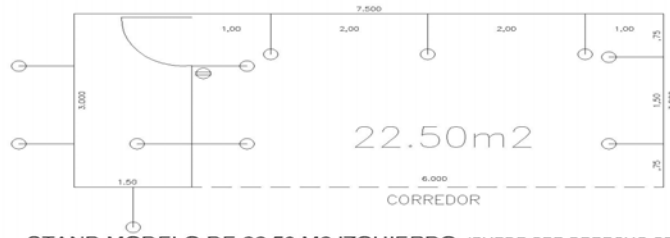

STAND MODELO DE 22.50 M2 IZQUIERDO. (PUEDE SER DERECHO SEGUN LOCALIZACION.)

- 9 SPOTS PARA STAND MEDIANERO Y 11 PARA STAND ESQUINERO
- 11.00 ML DE PERIMETRO INTERNO POR 3.66 MTS DE ALTURA. ( NO INCLUYE 1 ML DE PUERTA)
- 1.50 ML DE PERIMETRO EXTERNO ADICIONAL POR 3.66 MTS DE ALTURA PARA STAND MEDIANERO
- 4.50 ML DE PERIMETRO EXTERNO ADICIONAL POR 3.66 MTS DE ALTURA PARA STAND ESQUINERO
- SPOT BRAZO SENCILLO EXTENDIBLE, BOMBILLA HALOGENA DE 150 WATTS / 110V
- ⊗ TOMACORRIENTE DOBLE 1500 WATTS / 110V

## 5.-PRELIMINARY SCHEDULE

DESCRIPTION	DATE
Call for galleries	February 18 <sup>th</sup> 2010
Last date for submitting the Admission Request	June 30 <sup>th</sup> 2010
Selection Comitee´s reunión (Selección of galleries and individual projects)	July 9 <sup>th</sup> 2010
Publication of the selected galleries	July 21 <sup>th</sup> 2010
First payment: 50% of the stand value	July 30 <sup>th</sup> 2010
Full payment of catalog spaces and individual project	July 30 <sup>th</sup> 2010
Call for museums, foundations, magazines and others	July 30 <sup>th</sup> 2010
Handing over of photographs and information for the catalog (obligatory)	August 17 <sup>th</sup> 2010
Final payment (50%)	September 10 <sup>th</sup> 2010
Request to Corferias for additional implements (furniture, lamps, phone lines etc. The rates are given by Corferias)**	Until October 5 <sup>th</sup> 2009
Handing over of natonal galleries´ Works in Corferias**	October 19 <sup>th</sup> 2010
Mounting of stands**	October 19 <sup>th</sup> 2010
Pre - opening**	October 20 <sup>th</sup> 2010, at 4:00 p.m.
Opening**	October 20 <sup>th</sup> 2010, at 7:00 p.m.
Fair will be open**	Between october 21 <sup>st</sup> and October 25 <sup>th</sup> . Between noon and 8:00 p.m.
Closing	Octubre 25 a las 8:00 p.m.
Unmounting	Octubre 26 de 2010

\*\* Data not confirmed